



POLAR
=FASTENERS=

DIN 6915

Benzeri - Similar - Ähnlich
DIN EN 14399-4

- Altıköşe Ağır Yük Somunu
- Hexagon Nuts with Large Widths Across Flats
- Sechskantmuttern mit großer Schlüsselweiten

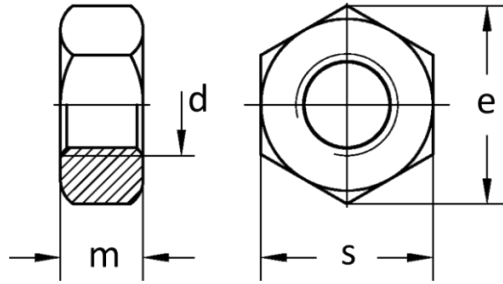

d	M 12	M 16	M 20	M 22	M 24	M 27	M 30	M 36
P (pitch)	1,75	2	2,5	2,5	3	3	3,5	4
m	10	13	16	18	19	22	24	29
s	22	27	32	36	41	46	50	60
e	23,91	29,56	35,03	39,55	45,20	50,85	55,37	66,44