

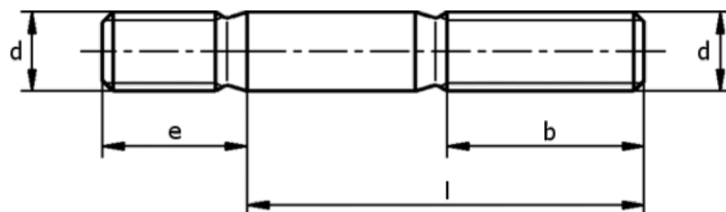

DIN 940

- Saplama
- Studs, Metal End $\approx 2,5 d$
- Stiftschrauben, Einschraubende $\approx 2,5 d$



d	M 4	M 5	M 6	M 7	M 8 (8x1)	M 10 (10x1,25)	M 12 (12x1,25)
b ($l \leq 125$)	14	16	18	20	22	26	30
b ($125 < l \leq 200$)	20	22	24	26	28	32	36
b ($l > 200$)	–	–	–	–	–	45	49
e	10	13	15	18	20	25	30
l	20-40	22-50	25-60	28-70	30-80	35-100	40-120

d	M 14 (14x1,5)	M 16 (16x1,5)	M 18 (18x1,5)	M 20 (20x1,5)	M 22 (22x1,5)	M 24 (24x2)
b ($l \leq 125$)	34	38	42	46	50	54
b ($125 < l \leq 200$)	40	44	48	52	56	60
b ($l > 200$)	53	57	61	65	69	73
e	35	40	45	50	55	60
l	45-140	50-160	55-180	60-200	65-200	70-200