

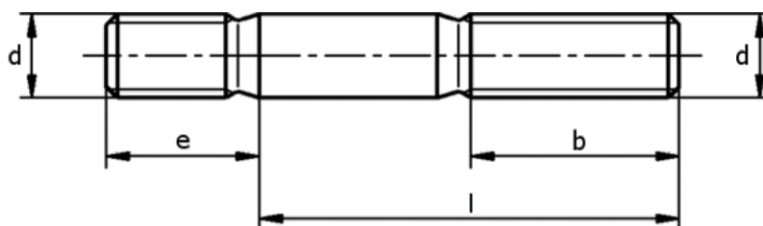

## DIN 938

- Saplama
- Studs, Metal End  $\approx 1 d$
- Stiftschrauben, Einschraubende  $\approx 1 d$



d	M 3	M 4	M 5	M 6	M 7	M 8 (8x1)	M 10 (10x1,25)	M 12 (12x1,25)
b ( $l \leq 125$ )	12	14	16	18	20	22	26	30
b ( $125 < l \leq 200$ )	18	20	22	24	26	28	32	36
b ( $l > 200$ )	—	—	—	—	—	—	45	49
e	3	4	5	6	7	8	10	12
l	18-30	20-40	22-50	25-60	28-70	30-80	35-100	40-120

d	M 14 (14x1,5)	M 16 (16x1,5)	M 18 (18x1,5)	M 20 (20x1,5)	M 22 (22x1,5)	M 24 (24x1,5)	M 27 (27x2)	M 30 (30x2)
b ( $l \leq 125$ )	34	38	42	46	50	54	60	66
b ( $125 < l \leq 200$ )	40	44	48	52	56	60	66	72
b ( $l > 200$ )	53	57	61	65	69	73	79	85
e	14	16	18	20	22	24	25	30
l	45-140	50-160	55-190	60-200	65-200	70-200	75-280	80-300



**POLAR**  
=FASTENERS=

d	M 33 (33x2)	M 36 (36x3)	M 39 (39x3)	M 42 (42x3)	M 45 (45x3)	M 48 (48x3)	M 52 (52x3)
b (l≤125)	72	78	84	90	96	102	110
b (125<l≤200)	78	84	90	96	102	108	116
b (l>200)	91	97	103	109	115	121	129
e	32	35	38	42	45	48	52
l	90-340	35-360	110-400	110-400	120-400	120-400	140-400